

### DEMOLITION NOTES

1. CONTRACTOR SHALL BE RESPONSIBLE FOR ALL LABOR, MATERIALS, EQUIPMENT, SUPERVISION, COORDINATION EFFORTS, PERMITTING COSTS, CERTIFICATE COSTS, SERVICES, FILING FEES, TESTING COSTS, SECURITY, INSURANCE AND ALL OTHER ASSOCIATED OR RELATED ITEMS REQUIRED TO COMPLETE THE SCOPE OF WORK DESCRIBED IN THIS SECTION.
2. MONTCLAIR STATE UNIVERSITY TO INSTALL AND MAINTAIN A TEMPORARY EIGHT-FOOT HIGH CHAIN-LINK FENCE WITH ENTRANCE GATES AT LOCATIONS INDICATED AND AS REQUIRED TO PROPERLY AND SAFELY SECURE THE DEMOLITION OPERATION IN ACCORDANCE WITH LOCAL AND STATE REQUIREMENTS.
3. NOTIFY TRANSCO GAS PRIOR TO DISTURBING AREAS LOCATED WITHIN THE 30-FT WIDE TRANSCO GAS PIPELINE EASEMENT. THE EXISTING GAS PIPELINE IS TO REMAIN AND BE PROTECTED.
4. INSTALL AND MAINTAIN ROADWAY CONSTRUCTION SIGNAGE AND ASSOCIATED TRAFFIC MEASURES.
5. INSTALL AND MAINTAIN SOIL EROSION AND SEDIMENT CONTROL MEASURES. THE CONTRACTOR IS RESPONSIBLE FOR CLEANING THE ADJACENT ROADWAYS DUE TO DEMOLITION RELATED DEBRIS, DUST AND SEDIMENT AS NECESSARY OR AS DIRECTED BY THE OWNER OR OWNER'S ENGINEER.
6. IMPLEMENT ALL SAFETY MEASURES AND ANY OTHER MEASURES DEEMED NECESSARY OR REQUIRED BY GOVERNING AUTHORITIES TO PROTECT FROM HARM OR DAMAGE ADJACENT AND ON-SITE PERSONS, PROPERTY, BUILDINGS, HOMES, BUSINESSES, FACILITIES AND UTILITIES.
7. REMOVE AND LEGALLY DISPOSE OF ALL CONTENTS OF THE BUILDING TO BE DEMOLISHED UNDER THIS CONTRACT, INCLUDING, BUT NOT NECESSARILY LIMITED TO: FURNISHINGS, MECHANICAL EQUIPMENT, PLUMBING FIXTURES, FURNITURE, CABINETS, AND SUCH.
8. PURGE, EVACUATE AND PROPERLY DISPOSE OF ALL RESIDUAL OILS, GASES, ETC. FROM THE MECHANICAL AND PLUMBING SYSTEMS AND ALL OTHER SIMILAR SYSTEMS OF THE BUILDING TO BE DEMOLISHED UNDER THIS CONTRACT IN ACCORDANCE WITH NJDEP AND LOCAL REQUIREMENTS.
9. DISCONNECT AND CAP/TERMINATE ALL BUILDING SERVICES, E.G. WATER, SEWER, GAS, ELECTRIC, TELEPHONE, ETC. IN ACCORDANCE WITH ALL LOCAL REGULATIONS AND UTILITY SERVICE COMPANY REQUIREMENTS. WHERE NECESSARY, THE WORK SHALL INCLUDE THE RESTORATION OF PAVEMENT AND CURBING IMPACTED BY UTILITY REMOVAL AND DEMOLITION WORK. ALL EXISTING UTILITIES SHALL BE FIELD-VERIFIED AND ANY DISCREPANCIES SHALL BE REPORTED TO THE OWNER AND OWNER'S ENGINEER.
10. OBTAIN AND PAY FOR TEMPORARY UTILITY (WATER, ELECTRIC, TELEPHONE) AND OTHER SERVICES NECESSARY FOR PROPER EXECUTION OF THE DEMOLITION WORK.
11. REMOVE AND LEGALLY DISPOSE OF OFF-SITE HAZARDOUS MATERIALS (LIGHTING/TRANSFORMER BALLASTS, FLUORESCENT LIGHTS, ETC.) FROM THE BUILDINGS TO BE DEMOLISHED.
12. REMOVE AND DISPOSE OF OFF-SITE ALL EXISTING SITE FEATURES, INCLUDING BUT NOT LIMITED TO ALL FENCING, GATES, WALLS, STAIRWAYS, RAILINGS, AND FREE-STANDING ITEMS (E.G. BOLLARDS, SIGNS, SIGN POSTS, WALLS, CANOPIES, ETC.) WITHIN SITE AREAS.
13. COMPLETELY DEMOLISH AND RECYCLE, TO THE GREATEST EXTENT POSSIBLE, ALL UNCONTAMINATED CONCRETE/MASONRY DEBRIS GENERATED FROM THE BUILDINGS.
14. DEMOLISH AND COMPLETELY REMOVE ALL UTILITIES INCLUDING STORM SEWER LINES, TELEPHONE, ELECTRIC, GAS, DOMESTIC WATER SERVICE AND SANITARY SEWER LINES AND APPURTENANCES INCLUDING BUT NOT LIMITED TO PITS, SANITARY MANHOLES, PIPING, ETC., EXCEPT THOSE INDICATED TO REMAIN ON THE CONTRACT DRAWINGS.
15. DEMOLISH AND REMOVE ALL UNDERGROUND OBSTRUCTIONS INDICATED ON THE CONTRACT AND REFERENCE DRAWINGS.
16. SECURE THE WORK SITE FOR THE DURATION OF THE PROJECT ON AN AROUND-THE-CLOCK BASIS TO PREVENT UNAUTHORIZED ENTRY INTO THE SITE.
17. THE SITE SHALL BE GRADED TO MATCH ELEVATIONS AS INDICATED ON DRAWING CE101 (FINAL GRADING AND SOIL EROSION AND SEDIMENT CONTROL PLAN) USING DENSE GRADED AGGREGATE (DGA).
18. PROVIDE THE REQUIRED INSPECTION, TESTING AND PROGRESS REPORTS TO THE OWNER.

Date	Description	No.
10/1/2024	ISSUED FOR BID	2
8/7/2024	ISSUED FOR PLAN REVIEW	1

Revisions

Signature: CHRIS CIRROTTI  
 PROFESSIONAL ENGINEER NJ  
 Lic. No. 24GE03853800

**LANGAN**  
 Langan Engineering and Environmental Services, LLC  
 300 Kimball Drive  
 Parsippany, NJ 07054  
 T: 973.560.4900 F: 973.560.4901 www.langan.com  
 NJ Certificate of Authorization No. 24GA27996400

Project: **MSU NEW CSAM BUILDING**  
 MONTCLAIR NEW JERSEY

Drawing Title: **DEMOLITION PLAN**

Project No. <b>100985401</b>	Drawing No. <b>CD101</b>
Date <b>8/7/2024</b>	
Drawn By <b>SLA</b>	
Checked By <b>PGM</b>	
Sheet <b>1</b> of <b>2</b>	

MSU Project No. 24C034

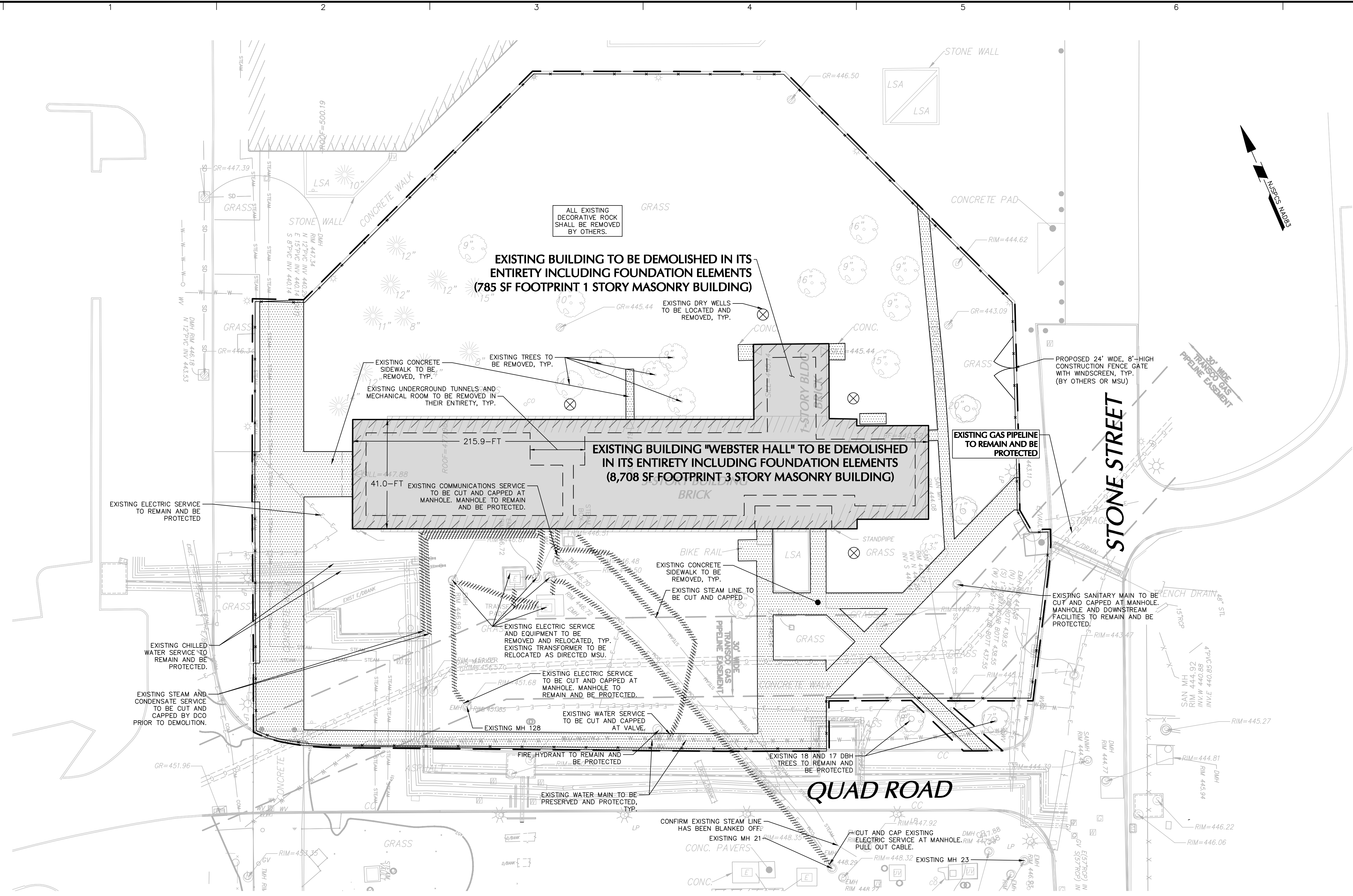

**EXISTING BUILDING TO BE DEMOLISHED IN ITS ENTIRETY INCLUDING FOUNDATION ELEMENTS (785 SF FOOTPRINT 1 STORY MASONRY BUILDING)**

**EXISTING BUILDING "WEBSTER HALL" TO BE DEMOLISHED IN ITS ENTIRETY INCLUDING FOUNDATION ELEMENTS (8,708 SF FOOTPRINT 3 STORY MASONRY BUILDING)**

**REFERENCE NOTE:**  
 1. BOUNDARY AND TOPOGRAPHIC INFORMATION OBTAINED DRAFT SURVEY PREPARED BY LANGAN ENGINEERING AND ENVIRONMENTAL SERVICES, LLC.  
 2. EXISTING UTILITY INFORMATION OBTAINED FROM AS-BUILT SURVEY ENTITLED "DCO/MONTCLAIR STATE UNIVERSITY CAMPUS CEC/CHCP PROJECT, MONTCLAIR/LITTLE FALLS, NEW JERSEY, CEC/CHCP AS-BUILT," DATED JANUARY 10, 2013, LAST REVISED JUNE 18, 2013.

SYMBOL	DESCRIPTION
—x—	8"-HIGH CHAIN-LINK CONSTRUCTION FENCE
---	CONTRACT LIMIT LINE
▨	EXISTING STRUCTURE TO BE DEMOLISHED
▨▨▨▨	EXISTING UTILITY LINE TO BE REMOVED
▨▨▨▨▨▨	EXISTING CONCRETE TO BE REMOVED
⊗	DRY WELL TO BE REMOVED

SYMBOL	DESCRIPTION
⊕	HYDRANT
⊙	MANHOLE
⊕	WATER VALVE
□	CATCH BASIN
○	SPOT ELEVATION
○	CLEAN OUT
—x—	FENCE
—T—	SIGN
—D—	STORM
—SS—	SANITARY
—G—	GAS
—W—	WATER
—E—	ELECTRIC
—COM—	TELECOM
—STEAM—	STEAM
☀	LIGHT POLE

**THE CONTRACTOR SHALL DEMOLISH AND REMOVE ALL SITE ELEMENTS UNDER THIS CONTRACT INCLUDING, BUT NOT LIMITED TO CONCRETE WALLS, BOLLARDS, STAIRWAYS, RAILS, CONCRETE PADS, ETC. WITHIN THE CONTRACT LIMITS UNLESS OTHERWISE SHOWN TO REMAIN.**