

# BE YOUR OWN TOUR GUIDE



**MONTCLAIR STATE UNIVERSITY**

Office of Undergraduate Admissions

973-655-4444 • 1 Normal Ave, Montclair, NJ 07043 • [montclair.edu/admissions](http://montclair.edu/admissions)

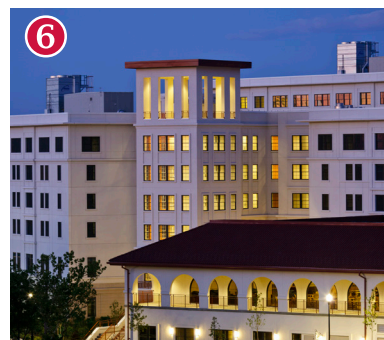
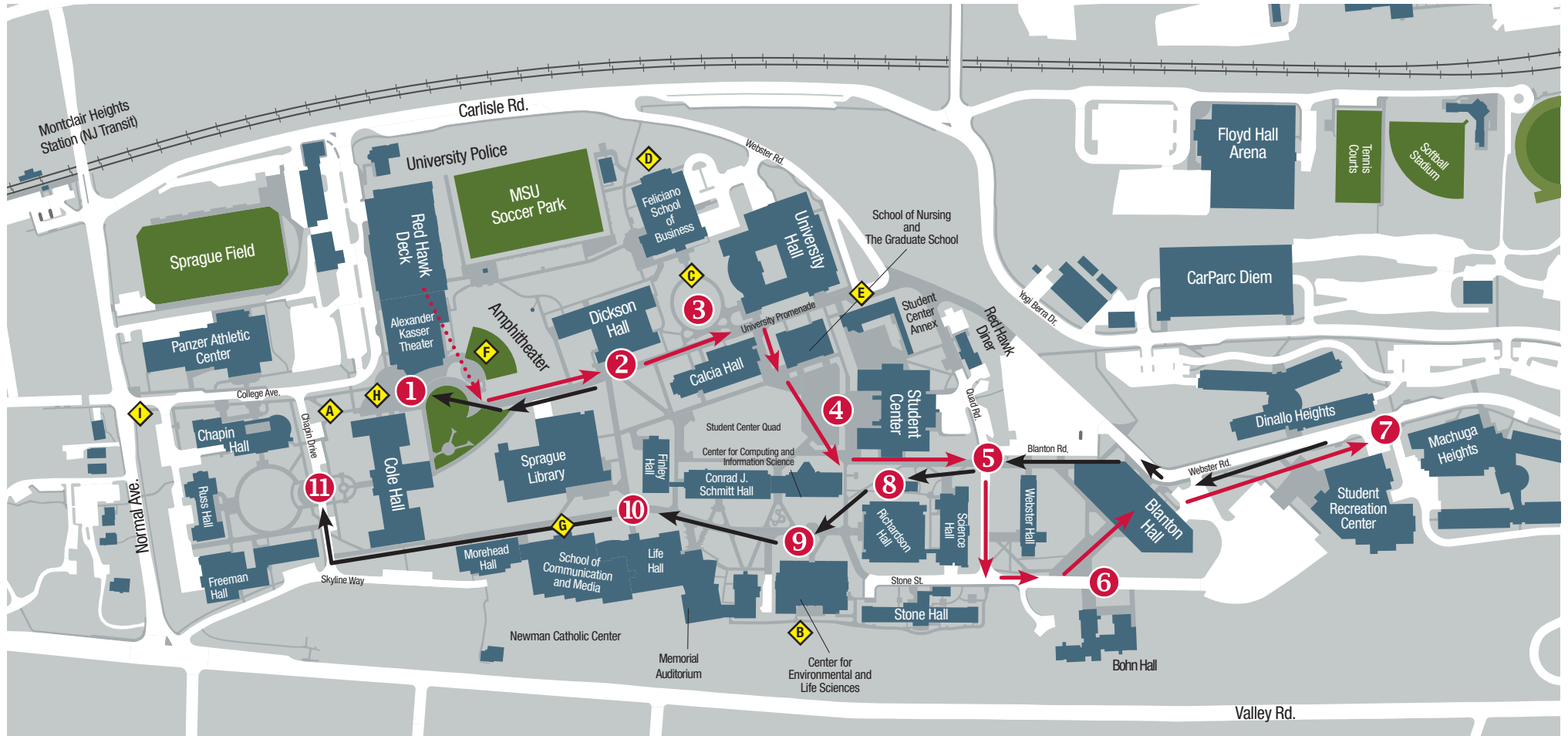

Make sure to **take selfies at these spots**  and use #RedHawkPride when you post!

- A. Red Hawk Statue
- B. NYC skyline behind the Center for Environmental and Life Sciences
- C. Courtyard between the Feliciano School of Business and University Hall
- D. 4th floor balcony in the Feliciano School of Business
- E. "Red Hawk Country" on the side of the Student Center Annex
- F. Amphitheater
- G. The School of Communication and Media lobby
- H. The white statues and the arches outside College Hall
- I. The "Montclair State University" sign at the main entrance on the corner of Normal Ave and College Ave

 Follow red arrow for Stops 1-6

 Follow black arrow for Stops 6-10

# BE YOUR OWN TOUR GUIDE

## STOP 1

### **Amphitheater and Alexander Kasser Theater**

Kasser Theater offers student shows, Peak Performances and off-Broadway shows, and an open-air amphitheater is right next door.

### **Red Hawk Parking Deck and George Segal Gallery**

A visitor parking deck with the George Segal Gallery located on the fourth floor. The gallery, named after the renowned sculptor, presents exhibits throughout the academic year.

### **University Police Department**

A fully certified and operational law enforcement agency, the University Police Department serves the Montclair State community. The University Police and EMS are always available by phone at 973-655-5222. With an Emergency Blue Light system and Rave Guardian, a student will never feel unsafe or alone on campus at any time. Family members and guests can join the emergency alert system by texting "montclairstatealerts" to 226787.

### **Sprague Field**

Home to many Red Hawks NCAA sports teams including football, field hockey and lacrosse.

### **Panzer Athletic Center**

With three gymnasiums, an Olympic sized swimming pool and fitness center, this athletic center houses the 18 NCAA Division III teams on campus.

### **Cole Hall – Red Hawk Central**

First and only building on campus when the University opened in 1908 as the New Jersey State Normal School at Montclair. Home of Red Hawk Central, and central location for all student services including: Undergraduate Admissions, Financial Aid, Student Accounts, Honors Program, President's Office and more.

## STOP 2

### **Dickson Hall**

The College of Humanities and Social Sciences houses programs like: Anthropology, English, Philosophy, Languages and many more.

## STOP 3

### **Feliciano School of Business**

The Feliciano School of Business is accredited by the Association to Advance Collegiate Schools of Business (AACSB) International, the highest accreditation for business schools worldwide. The School contains the Feliciano Center for Entrepreneurship, a lecture hall, study rooms, a 3D Printing Lab and a trading floor.

### **University Hall**

The College of Education and Human Services contains several different departments in Education, Exercise Science, Nutrition, Family Science and Human Development, Teacher Education and many more.

### **The School of Nursing and The Graduate School**

The School of Nursing offers RN to BSN, 4-year BSN and new online MSN degrees. The facility contains a simulation center with high fidelity manikins, health care labs and much more. The Graduate School is also located here.

### **Calcia Hall**

Main facility for the Art and Design department of the College of the Arts. It contains fine arts specialization studios for drawing, sculpture, ceramics, jewelry-making, photography and more.

## STOP 4

### **Student Center**

With over 100+ student organizations, the main hub for student activity is here. Inside is the student café, Student Government Association, the University Bookstore, a Surf-N-Print Lab, an Information Help Desk and Red Hawk Nest for students to relax.

## STOP 5

### **Red Hawk Diner**

Open from 10 a.m. until 10 p.m., 7 days a week - the perfect place for a late night snack!

### **Meal Plans**

University meal plans are available for resident and commuter students and include Red Hawk Dollars, Swipes, Red Hawk Unlimited, Flex Dollars and more. To learn more, visit [montclair.edu/dining](http://montclair.edu/dining).

## STOP 6

### **Blanton Hall**

Housing all level students with a suite-style design accommodating 2-3 roommates per room, connected by a single bathroom. The main atrium contains eateries such as Dunkin' Donuts, Chili's and Jersey Mike's.

### **University Health Center**

The UHC offers physicals, medical screenings, diagnosis and treatment, and on-site prescription medication for all students.

### **Bohn Hall**

More than 600 freshman students are housed in this community-style residence hall. Attached to the building is the Center for Writing Excellence to assist students with any writing needs.

### **Stone Hall**

A new residence hall designed in a community style for new freshman and transfer students.

## STOP 7

### **The Heights Complex**

Dinallo and Machuga Heights house over 2,000 students of all levels. The rooms offer two living styles, either double or single style which is one open floor plan or one room broken into two smaller suites. Each style has its own bathroom and temperature control. The complexes have lounges, community kitchens and game rooms.

### **Pulse on Dining at Sam's Place – Machuga Heights**

A buffet-style dining area set up with vegetarian, vegan and allergen-free options. Attached to Sam's Place is Bistro 62, a late-night eatery.

### **Student Recreation Center**

This center is open to all students free of charge. Containing multiple floors and activities such as free weights, swimming pool, racquetball courts, basketball courts, indoor track, game area, equipment rental, club/recreational sports, Group X classes, personal trainers, cardio equipment and free lockers.

## STOP 8

### **Science Hall**

Home to research and teaching labs for the Department of Biology. Built to resemble the layout of a hospital for a life-like educational setting.

### **Drop-In Center – Health Promotion**

Health Promotion provides education, outreach and advocacy to enhance the health of all students, faculty and staff.

### **Richardson Hall**

Home to the College of Science and Mathematics' research facilities and programs that sustain and grow high-demand science programs. Included are classrooms, research labs, teaching labs and instructional facilities.

## STOP 9

### **Center for Environmental and Life Sciences**

Home to Earth and Environmental Studies and many other programs, the Center features Electron Microscopy and Geographic Information Labs, with a beautiful NYC skyline view.

### **Center for Computing and Information Science, Schmitt Hall, Finley Hall**

Three interconnected buildings that are home to Computer Science programs, language and math labs, testing centers, Modern Languages and Literatures, and Spanish and Latino Studies. Finley Hall holds the Product Design program.

### **Memorial Auditorium**

One of three auditoriums on campus, Memorial Auditorium can seat 1,000 and hosts many events, recitals, concerts and other student activities.

## STOP 10

### **Life Hall**

Home to the Department of Theatre and Dance, Life Hall features a dance studio and small black-box theater.

### **School of Communication and Media**

Home to programs like Communication Studies, Journalism, Television Production and more. Facilities include a 175-seat presentation hall, 4K control rooms, Foley stage production and more.

### **Morehead Hall**

Offices for the College of the Arts and School of Communication and Media are located here along with lounges and pantries for students.

### **Sprague Library**

A three-floor library with over 1 million books, periodicals and documents, and laptop lending.

## STOP 11

### **Chapin Hall**

Home to the John J. Cali School of Music, this building houses all music programs such as Music, Music Therapy/Performance and Music Education. The Jed Leshowitz Recital Hall and sound-proof rehearsal rooms are located here as well.

### **Freeman Hall and Russ Hall**

A complex of two suite style residence halls with an all-you-can-eat dining hall in the middle. Housing all level students, there are double-occupancy rooms that are connected by a conjoining bathroom for each suite.

We hope you enjoyed your visit.  
View our other visit options at  
[montclair.edu/visit](http://montclair.edu/visit).

 MSUadmission

 MontclairStateAdmissions

 MSUadmission

Share using #RedHawkReady

 **MONTCLAIR STATE UNIVERSITY**